

1 SUITE LAYOUT - BACHELOR 'A'
3/8" = 1'-0"

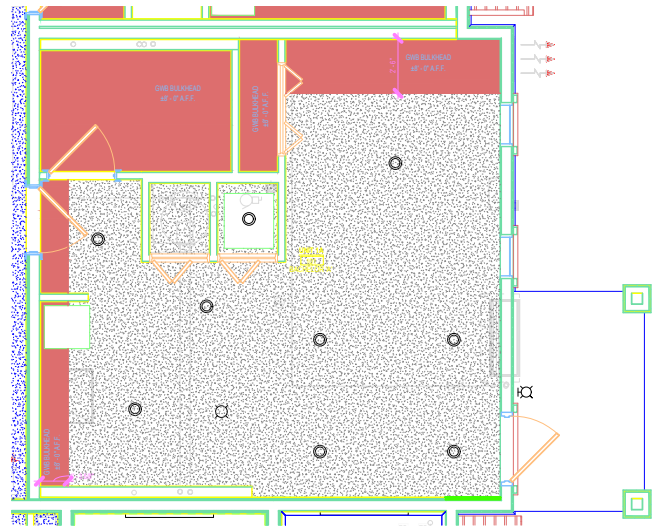

2 REFLECTED CEILING PLAN - BACHELOR 'A'
3/8" = 1'-0"

GENERAL NOTES

IMPERIAL:
ALL DIMENSIONS ARE IN FEET AND INCHES UNLESS OTHERWISE NOTED.
METRIC IN BRACKETS.

THE CONTRACTOR SHALL VERIFY AND BE RESPONSIBLE FOR ALL DIMENSIONS. DO NOT SCALE THE DRAWING. ANY ERRORS OR OMISSIONS SHALL BE REPORTED TO THE ARCHITECT IMMEDIATELY.

THE CONTRACTOR TO ALL DESIGN AND DRAWINGS ARE THE PROPERTY OF THE ARCHITECT. REPRODUCTION OR USE FOR ANY PURPOSE OTHER THAN THAT AUTHORIZED BY ARCHITECT IS FORBIDDEN.

REV	DATE	DESCRIPTION
REVISIONS		
4		
3	10 JAN 25	ISSUED FOR CONSTRUCTION
2	20 APR 24	ISSUED FOR BUILDING PERMIT
1	09 MAR 24	ISSUED FOR COORDINATION

NO.	DATE	DESCRIPTION
ISSUANCES		
DP#:	07/8/24	
DP#:	2003.19	

SITEFINDERS REAL ESTATE SERVICES

OFFICE ADDRESS: Rob Roycroft (204) 483-5391

THE GRAIN ELEVATOR

PROJECT ADDRESS: 307 11 AVE NW
HIGH RIVER, ALBERTA
T1V 0W6

LOT: 2
BLOCK: 2
PLAN: 04T 2002

UNIT LAYOUT - BACHELOR "A"

DATE: 04 NOV 25	A3.0
SCALE: 3/8" = 1'-0"	